

A photograph of three young women, likely hotel staff, smiling and looking towards the camera. They are wearing white long-sleeved shirts with dark suspenders. The woman on the left has blonde hair and is wearing a necklace. The woman in the middle has brown hair styled in a braid and is wearing orange lipstick. The woman on the right has dark hair and is wearing glasses. The background is dark and out of focus, suggesting an indoor setting with warm lighting.

**Welcome
to Platzl Hotel**



„Platz“

HOTEL

Where Munich's
heart beats



Modern Hotel Tradition

The Platzl Hotel – a Munich original!

Lively hospitality, traditional values, distinctive service! Our house has been firmly in family hands for three generations, and while much has been modernized over the years, one constant remains: The joy of welcoming, hosting, catering to and sending guests on their journey with a good feeling – down to earth, humane, genuine!

It begins in our open lobby, continues in the elegantly decorated rooms, and finds a delicious culmination in our locally inspired restaurants. Not only guests who want to discover Munich on a holiday, but also motivated business travelers will find the right setting with us: Our meeting area, completely renovated only a few years ago, will win you over with the right mix of charm, functionality and spatial diversity.

A true sense of well-being

Leather, loden wool, marbled wood

... all in the warm Platzl colors – plus quality linen. Our privately owned hotel with its 164 rooms and 15 suites exudes a warm and inviting sense of coziness.

Also “typically PLATZL” are our beer cosmetics from original Bavarian hops or the Mühldorfer brand pillow menu exclusively designed for us. An atmosphere as distinctive as Munich’s city center. A sense of living you would only find at home..

Room categories

CLASSIC

6 Single Rooms	~ 13/15 m ²
36 Queenbed Rooms	~ 22 m ²
4 Twin Rooms	~ 26 m ²
43 Double Rooms	~ 26 m ²

STANDARD

18 Queenbettzimmer	~ 15 m ²
1 Twin Rooms	~ 18 m ²
1 Double Rooms	~ 18 m ²

SUPERIOR

26 Double Rooms	~ 24 m ²
4 Twin Rooms	~ 24 m ²

DELUXE

21 Double Rooms	~ 28 m ²
4 Twin Rooms	~ 28 m ²





At the Pfister's home

Where history and modernity meet, a special atmosphere awaits:

Flour and grain were once stored in the historic Pfistermühle mill – today its heritage is reflected in our unique suites. With great attention to detail, they combine traditional craftsmanship, timeless elegance and Bavarian hospitality. Here you will find peace and quiet in the heart of Munich.



Room categories

Junior Suite „Journeyman's chamber“	28 to 35 m ² , max. 2 guests
Deluxe Junior Suite „Flour chamber“	33 to 39 m ² , max. 2 guests
Superior Suite „Granary suite“	41 to 43 m ² , max. 2 guests
Deluxe Suite „Pfister chamber“	57 to 60 m ² , max. 3 guests
Maisonette Suite „Grain floor“	56 to 62 m ² , max. 3 guests

Relax

overlooking the rooftops of Munich

Escape the hustle and bustle of the city and experience pure relaxation in our sweat room on the 5th floor, equipped with sauna, sanarium and cozy daybeds. Let yourself be pampered with a soothing massage from Bi PHiT and unwind from the pressures of everyday life. If you want to get active, the boutique gym is the ideal place to work out.

SPA

FACILITIES (daily from 10 a.m. to 11 p.m. / saunas until 10 p.m.)

Finnish Sauna (194° F)

Sanarium (149° F)

Rain showers

Relaxation area with comfortable daybeds

Refreshment area with water, tea and fruit

Luxurious cosmetics

Bathrobes, towels and sauna towels provided free of charge

Boutique Gym

EQUIPMENT (daily from 7 a.m. to 10 p.m.)

Matrix fitness equipment: Treadmill, fitness cycle, strength tower

Free weights, kettlebells, pull-up bars

TRX bands, BOSU balls

Yoga mats





Platz
HOTEL
Munich



Pfistermühle

**Handcrafted.
Passionate.
Authentic.**

The natural woodlands, nearby waters and expansive fields of the Munich countryside form the foundation of all dishes served at **Pfistermühle**. Regional producers supply finest ingredients to our young kitchen team, who passionately craft inspired dishes with skill and expertise.

We like the special, but also the down-to-earth. We focus on old recipes for the basics, while in the interpretation we like to demonstrate a joy of creativity. Instead of replacing them with modern elements, the Pfistermühle's decades-old interior was restored in 2017 with great attention to detail. Indulge in exquisite Bavarian cuisine while seated on historic stone floors beneath charming vaulted ceilings.

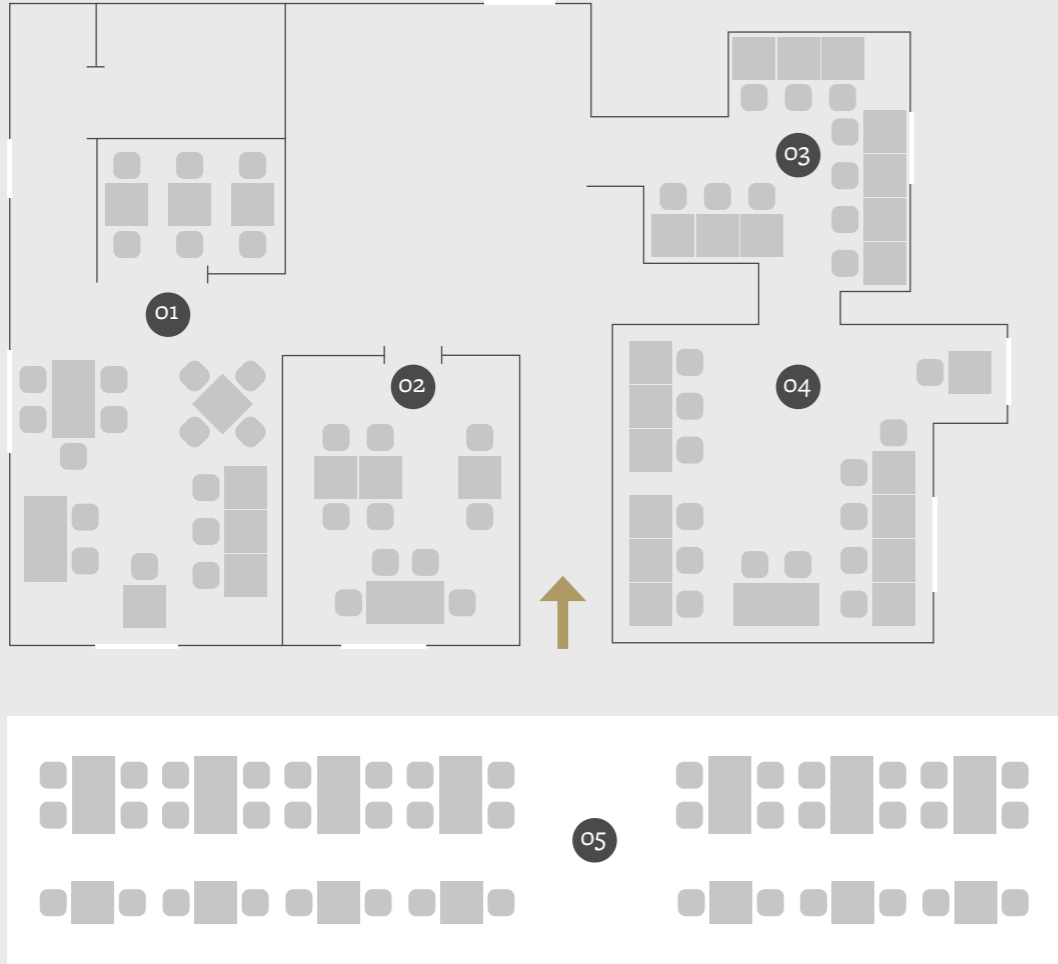

Capacities

Pfistermühle total	100 people	145 m ²
01 Bakery	32 people	37 m ²
02 Harvest chamber	12 people	13 m ²
03 Pfisterbach	26 people	26 m ²
04 Millstone	20 people	34 m ²
05 Terrasse	48 people	

Opening hours

Tue to Fr	11.30 a.m. to 11 p.m.
Sat	11.30 a.m. to 10 p.m.
Mon & Sun	closed





Ayinger am Platzl



Enjoy bavarian beer and delicacies

At **Ayinger am Platzl** we combine down-to-earth Bavarian food culture with a real love for hops. The latter has always been dear to the hearts of the Platzl owners. After all, the Ayinger Privatbrauerei has been run by the Inselkammer family for six generations.

Ayinger am Platzl authentically cultivates Munich's tavern tradition and dispenses altogether with old-fashioned attitudes. Bavarian hospitality is warm, down to earth, and close to the people.



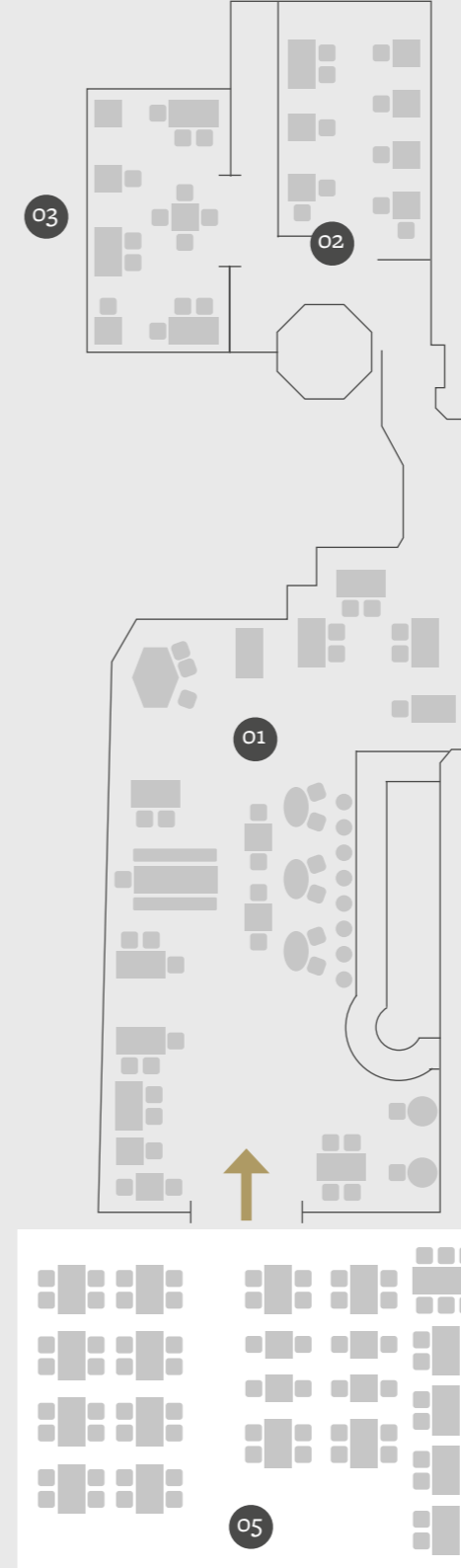

Capacities

Tavern total	169 people
01 Main seating area	119 people
02 Jagdstube	20 people
03 Group area	30 people
05 Terrace	80 people

Opening hours

Sun to Thur	11 a.m. to 11 p.m.
Fr & Sat	11 a.m. to 12 p.m.



Josefa

Our bar in the heart of Munich

Right in the heart of Munich, **Josefa** has long been a well-established and popular destination for travelers and Munich residents alike. The bar combines modern design and Bavarian tradition with a pinch of Italian amore per la vita and offers the perfect setting for enjoyable moments.

Josefa stands for highest quality and regionality: unique coffee roasts, developed together with the traditional Dallmayr company, selected spirits, carefully selected wines and seasonal delicacies make it a place where you can enjoy life to the fullest. The Josefa team gives you a warm welcome and ensures that every encounter feels special – whether for a quick espresso in the morning, a signature drink after work or relaxing hours with friends.

The ambience is an invitation to linger: Dark oak wood, handmade lamps and floral accents create a stylish yet cozy atmosphere. A place where Munich residents, tourists and hotel guests are welcome alike.

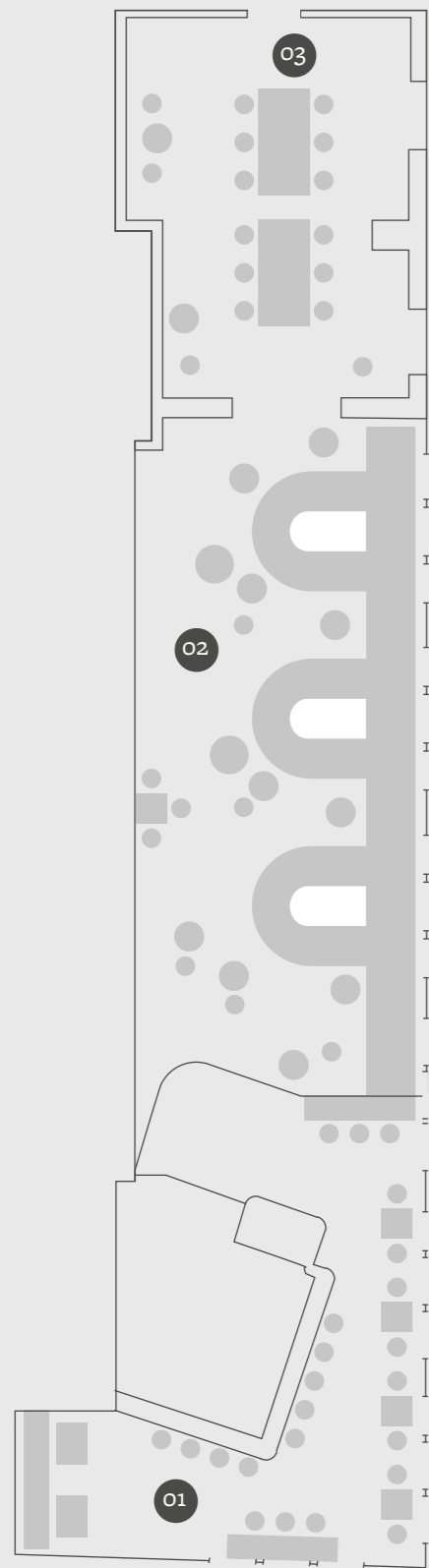

Capacities

01 Josefa	50 people
02 total Lobby & Co-Working-Space	100 people
03 Co-Working-Space	
sitting	10 people
standing	20 people

Opening hours
daily 7.30 a.m. to 12 p.m.



Josefa Karree

The lively outdoor bar

Josefa Karree, the outdoor area of **Josefa**, is a popular meeting place for all those who want to enjoy Munich's lively city life in the open air.

Here you can enjoy our popular *spatzl* or a cold espresso martini in a relaxed open-air atmosphere. Whether on a warm summer evening or a sunny fall day – **Josefa Karree** offers the ideal setting to watch the hustle and bustle of the city while sampling exclusive small delicacies.

Whether for Munich locals or guests from all over the world, from after-work get-togethers and atmospheric evenings with DJ music to relaxed parties in the open air – **Josefa Karree** is an oasis in the middle of the city.



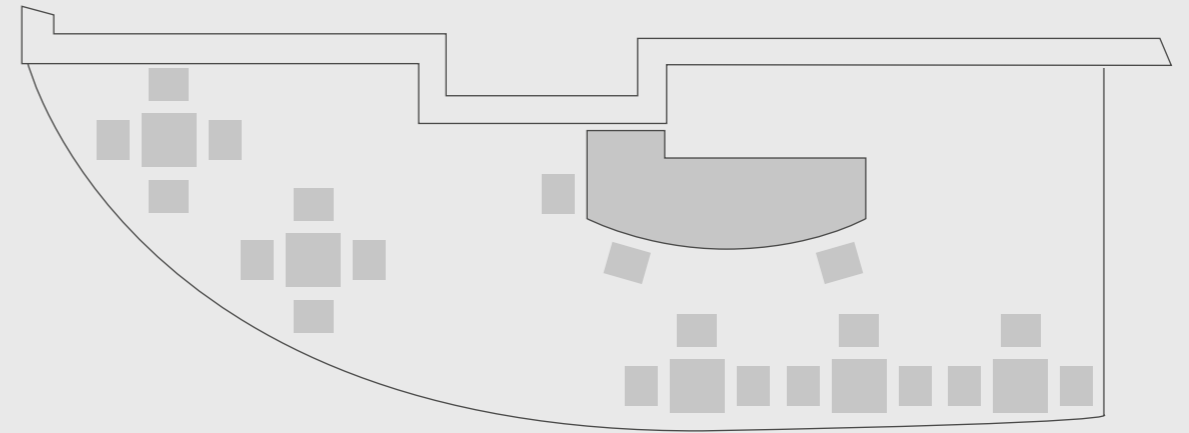

Capacities

Josefa Karree 70 people

Opening hours

Thur, Fr 4 p.m. to 10 p.m.
Sat 1 p.m. to 8 p.m.

Josefa Karree opens its doors only when the weather is favorable.



Meet and celebrate

Where Munich's heart beats

In our conference and event area, which was completely renovated a few years ago, you will find everything you need to ensure the success of your event. Modern presentation technology is combined with a charming mix of traditional and modern flair.

Choose the perfect setting for your meeting, conference or private celebration from our seven versatile rooms in different sizes. Our experienced team will be at your side from the planning stage to well beyond the event itself - making your celebration or conference in Munich not just an event, but a highlight.

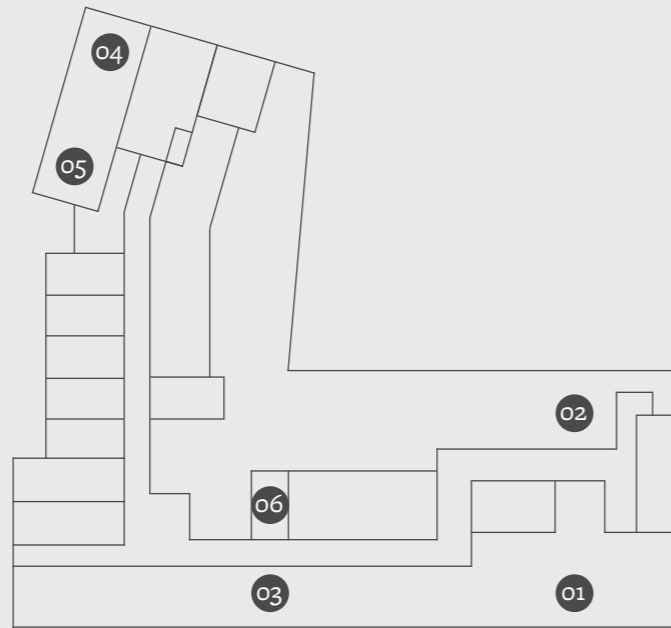

Name	m ²	Classroom Style	U-Shape	Boardroom Style	Theatre Style	Long Tables	Round Tables	Cocktail Style
01 Marktplatzl from 2 p.m.	158	80	56	60	120	120	80	150
02 Weiß-Ferdl-Stube	111	50	36	35	70	38	48	100
03 Karl-Valentin-Stube	70	25	20	26	50	32	40	70
04 Müller-Pfister-Stube	60	25	20	26	50	32	32	50
Müller-Stube	30	12	10	12	16	12	8	15
Pfister-Stube	30	12	10	12	16	12	8	15
05 Bäcker-Stube	24	-	-	12	12	12	8	10
06 Schmid-Wildy-Stube	26	-	-	10	-	10	-	-



Marktplatzl

Weiß-Ferdl-Stube

Karl-Valentin-Stube

Müller-Pfister-Stube

Bäcker-Stube

Schmid-Wildy-Stube

Microphone system

Microphone system

Projector with HDMI and VGA connection, 4000 ANSI Lumen, Screen format 3.0 m × 2.5 m (w × h), Bose sound system

Projector with HDMI and VGA connection, Screen format 1.3 m × 2.1 m (width × height), Bose sound system incl. micro

Projector with HDMI connection, Bose sound system, soundproof partition wall between the bakery and Müller-Pfister-Stube, LED spots in the round arches – choosable colours, microphone

Projector with HDMI connection, screen, Music via Bluetooth or RCA

Flat-screen TV with VGA connection, Bose sound system

Max. 1 microphone can be connected, 2 handheld and 1 Clip microphone in the house

Location & surroundings

The location could hardly be better

The **Platzl Hotel** is just a few steps away from Marienplatz and therefore in the immediate vicinity of the city's most famous sights. Whether you want to discover the Frauenkirche, the Viktualienmarkt or the Hofbräuhaus - it's all within easy walking distance. Thanks to the excellent public transport connections, you can also reach us quickly and easily from the main train station or directly from the airport. A location that perfectly combines comfort and experience!

How to reach us

by suburban railway (S-Bahn)	Marienplatz	2 min.	🚶
by underground railway (U-Bahn)	Marienplatz	2 min.	🚶

Distances

Marienplatz	0,1 miles	2 min.	🚶
Main station	1,0 mile	22 min.	🚶
trade fair	5,5 miles	19 min.	🚗
Airport	21,9 miles	31 min.	🚗

If you travel by car simply enter the following address into your navigation system: Sparkassenstraße 10, 80331 Munich

Public parking space is available in the immediate vicinity. Our guests also benefit from the underground parking area next to the hotel.



Neighborhood

There is much to discover around the **Platzl Hotel**. In fact, you can hardly choose a more interesting neighborhood when you come to Munich.

As in the **Platzl** itself, tradition and modernity go hand in hand. Emerging boutiques and restaurants, bedrock department stores, monuments and landmarks - all within walking distance.

The **Platzl Hotel** is your perfect accommodation to make acquaintance with the heart of Munich. Marienplatz, Staatstheater or Odeonsplatz are just a few hundred meters away, and all that separates you from the Sendlinger Tor, Stachus or University quarter is a short walk.



Pfiat di & see you soon

„Platzl“

HOTEL

Pfistermühle
Ayinger am Platzl
Josefa



PLATZL HOTEL

Sparkassenstraße 10
80331 Munich
+49 89 23 703 0
servus@platzl.de
www.platzl.de

**Event inquiries and
group requests**

+49 89 23 703 777
sales@platzl.de